

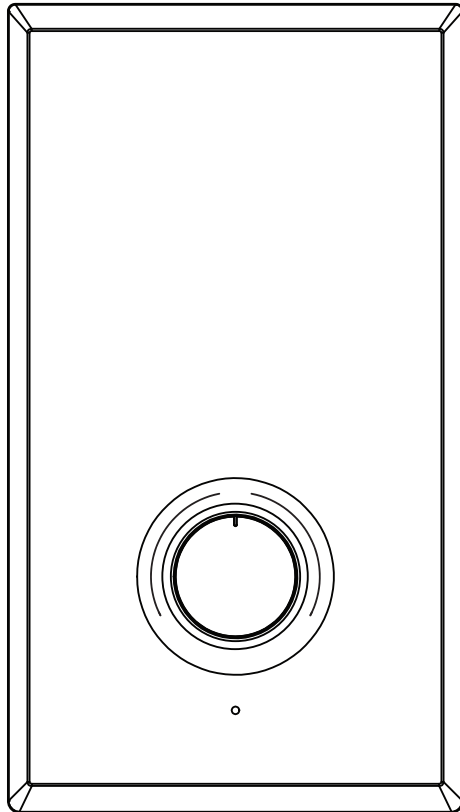

USER MANUAL



MODEL: DS SERIES



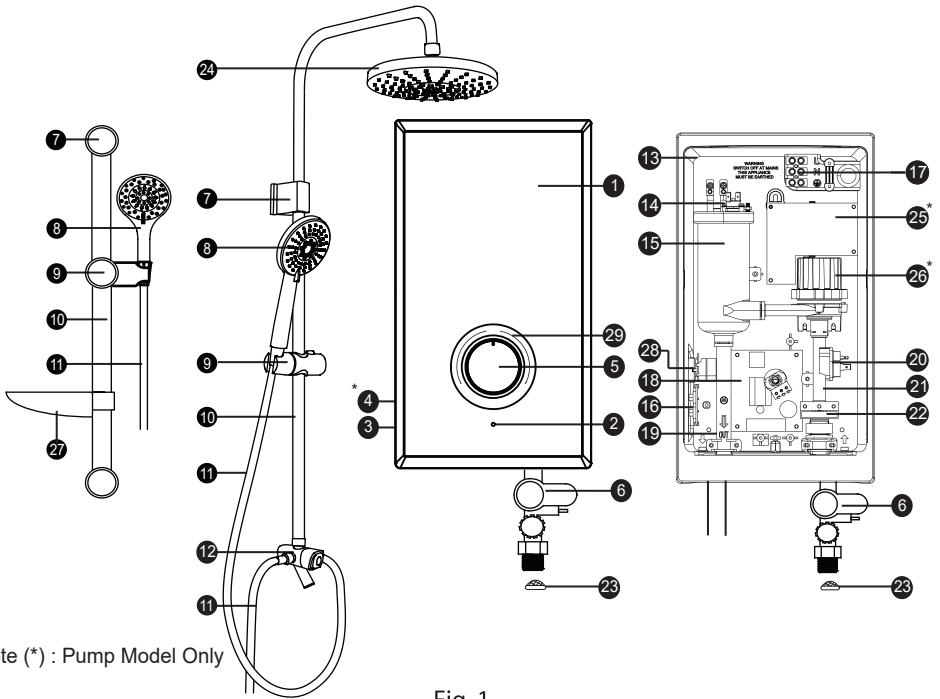

Note (*) : Pump Model Only

Fig. 1

- | | |
|------------------------------|-----------------------------|
| 1. Front Cover | 17. Terminal Block |
| 2. LED Indicators | 18. Main PCB Board |
| 3. Test & Reset Button | 19. Water Outlet Connection |
| 4. Pump Knob* | 20. TRIAC |
| 5. Temperature Control Knob | 21. Water Inlet Connection |
| 6. Stop Valve | 22. Reed Switch Assy |
| 7. Rail Support/Wall Bracket | 23. Mesh Filter |
| 8. Handshower | 24. Rain Shower Head |
| 9. Adjustable Shower Holder | 25. SMPS PCB Board* |
| 10. Slider Rail | 26. DC Pump* |
| 11. PVC Hose | 27. Soap Tray |
| 12. 3-in-1 Diverter Valve | 28. Pump VR* |
| 13. Heater Base | 29. Heat Illuminator |
| 14. Thermostat | |
| 15. Heater Tank | |
| 16. PCB Board (Test & Reset) | |

1. Stepless Power Control

Provides user the ability to adjust the water temperature precisely based on their own preferences.

2. Built-in Residual Current Device (RCD)

In the event of current leakage, Livinox's highly sensitive built-in RCD will cut off both live and neutral power supply

3. Inverter DC Booster Pump

In places where water pressure is inherently low, Livinox's state of the art DC pump can help boost water pressure with low noise operation and low energy consumption.

4. Double Thermal Anti-Scalding System

Our safety system cuts off power whenever the water temperature rises to 55°C (Anti-scalding) and 90°C (Abnormal overheat).

5. IP25 Splash Proof

Livinox's T-Series water heater comes with internationally recognised rating of IP25 protection. This means you can be rest assured that the internal electronics are always protected against dust and water.

6. Smart Self-Check Safety Indication

Livinox water heater comes with an intelligent self-check safety feature that informs the safety status of the heater before and during usage.

Self-checking function is indicated by power and RCD LED light running in sequence, after which, one of the following three scenarios may occur:

- a. Earth/RCD green light indicates that RCD is functioning normally and heater safe to use.
- b. Earth/RCD green light continuous blinking indicates that there is poor or no earth connection. User is advised to contact professional technician.
- c. Earth/RCD red light blinking indicates that current leakage is detected, and RCD has tripped. User is advised to contact professional technician.

7. Water Temperature Heat Illuminator*

Water temperature indication is illuminated around the temperature knob area, with blue light indicating minimum temperature and red light indicating maximum temperature.

(*) This feature is applicable only for certain models.

WARNING !

1. This installation shall comply with GP/ST/No.6/2016, Guideline for the Design, Installation, Inspection, Testing, Operation and Maintenance of water heater systems by energy Commission.
2. Products manufactured by us safe provided they are installed, used and maintained in good working order in accordance with our instruction and recommendations. Always refer to this manual if you have any doubt.
3. The appliance must be earthed. Improper grounding could cause electric shock.
4. If any of the following conditions occur, immediately switch off the mains and contact the sales agent for repair. Never attempt to repair the unit yourself.
 - If the Heater begins to make an odd noise, smell or smoke.
 - Heater digital display does not light up
 - Water temperature can not be controlled.
 - If the Heater shows signs of a distinct change in performance.
 - If found water leakage from inside.
5. For pump model, it is highly recommended to connect the Water Inlet Connection to tank storage supply otherwise it may cause damage to the Pump Motor.
6. The appliance is not intended for use by person (including children) with reduced physical, sensory or mental capabilities, or lack of experience and knowledge, unless they have been given supervision responsible for their safety.
7. Children should be supervised to ensure that they do not play with the appliance.
8. User is advised to test and adjust the water temperature before bathing.
9. In time of lightning/thunder, switch "off" the electric supply to the shower unit in advance to protect the shower unit against possible damage.
10. Metallic/chrome hose and conductive control valve shall not be used.
11. Installation shall be done by competence person recommended by the manufacturer.
12. This heater must be permanently connected to the direct main current supply. The use of a plug and socket is not recommended.
13. For the correct size of wire conductor corresponding to different electrical loading. Please refer to Table 1.
14. This heater operates at a minimum water flow rate of 2.0ltr/min and maximum working pressure of 6 bars. For direct connection to the water tank, the heater must have a minimum of 1.0m below the water tank.
15. This heater will not function if there is insufficient water flow (min 2.0ltr/min) to trigger the flow switch.
16. The built-in RCD will automatic cut off the power supply in case there is a current leakage as low as 15mA.
17. The thermostat will automatic cut off the power supply if it has sensed an abnormal rise in showering water temperature.
18. Plug, socket and undersized cable shall not be used.
19. This appliance is not to be used for portable water supply.
20. When removing the unit from package, small amount of water may found inside. This is normal as the unit is tested during manufacturing process.

HEATER UNIT INSTALLATION DIAGRAM

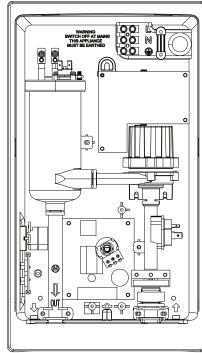

Fig.2

1. Select a suitable position in the bathroom.
2. Pull out the Temperature Control Knob and then remove the screw (A) at the bottom of the unit.
3. Remove the Front Cover from the bottom and then lift up the front cover.
4. Mark 3 Screw points of the Heater Base on the wall. The Heater position should be 1.5m above the bathroom floor.
5. Use 6mm diameter drill and make the wall plug holes in depth of 34mm.
6. Insert the wall plugs and mount the Heater firmly in position with the screws provided.

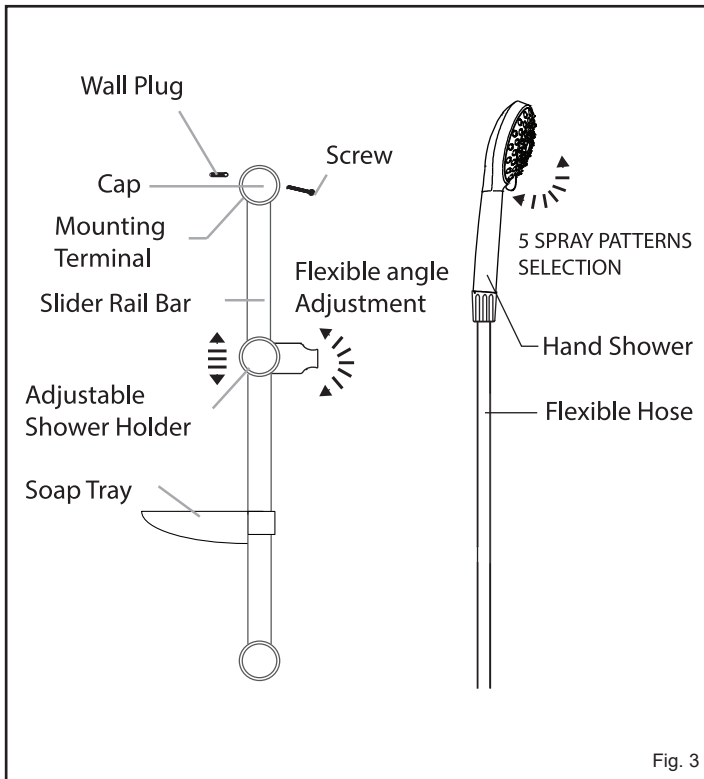
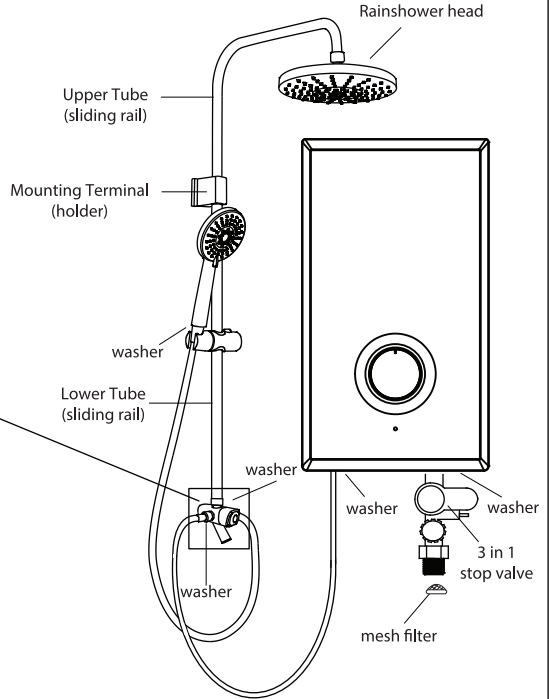
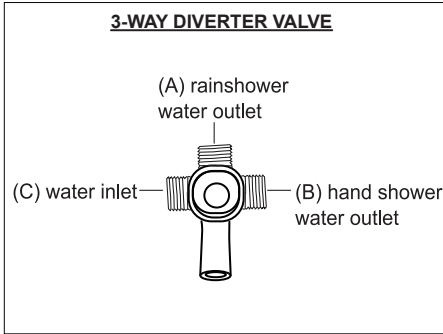
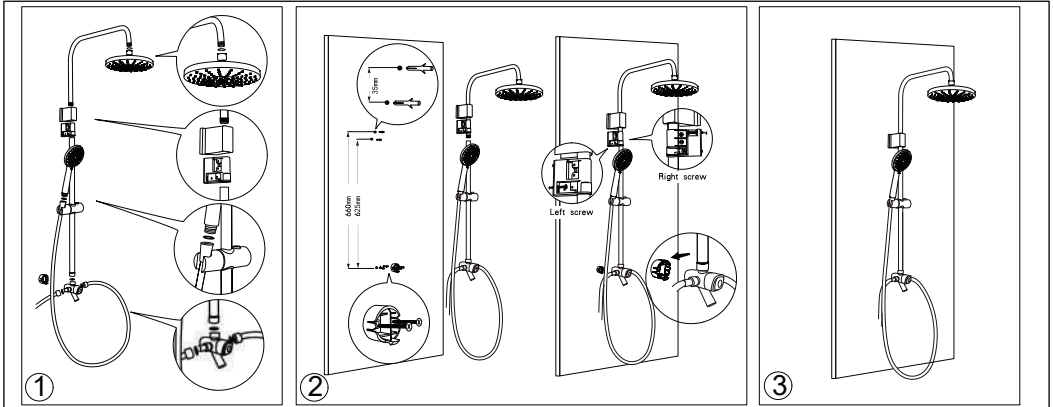

Fig. 3

1. Mark 2 screw points of the Shower Holder beside the Instant Hot Shower. It is recommended that the top of the portion is in level with the top of Heater Unit.
2. Use 6mm diameter drill and make the wall plug holes in depth of 34mm.
3. Insert the wall plugs and mount the Heater firmly in position with the 4 screws provided.
4. Insert the Shower Holder and Lower Rail Support into the Slider Rail.
5. Mount the Slider Rail to the Rail Bracket.
6. Remove the cap from the Rail Bracket and screw the Bracket to position.
Replace the cap.



IMPORTANT :

3-Way Diverter Valve

- A) Rainshower Water Outlet
- B) Hand Shower Water Outlet
- C) Water Inlet

1. Do marking for the location of the lower and upper bracket.
 2. Assemble the upper tube with rain shower and lower tube with divider.
 3. Hook the assembled divider to the mounted bracket.
 4. Tighten the screws and make sure all joints are completely connected to avoid leakage.
- Once the rainshower is connected to the water supply and you notice reduced water flow due to nozzle blockage, gently rub the nozzles with your fingers to help dislodge any debris and restore proper flow.

1. Only fixed and permanent connection is allowed, plug and socket shall not be used. In the case where direct connection cannot be made to the water heater, only correctly sized approved connector and connection shall be used.
2. For connection within the shower cubicle and below the ceiling, the connection box shall be IPX5.
3. An approved, correctly sized (MS IEC 60335-1:2013) copper flexible cable with maximum 1.5m length, shall be used to connect the water heater to the connection box.
4. Minimum cable size must not less than 4.0mm².
5. Appliance intended to be permanently connected to the water mains and not connected by a hose-set.
6. For Single point heater, the 'Water Outlet' can only be fitted to the Hose and Handshower set provided. No control valve or fitting can be fitted to the water outlet.
 - Connect the Stop Valve to the Water Inlet with washer. Use correct tools to tighten and be careful not to over tighten and damage the plastic nut.
 - Connect the incoming water piping (1/2" BSP) to the Stop Valve.
 - Make sure to put the Mesh Filter between Stop Valve and incoming water piping.
 - If any case, the Stop Valve is not use or omitted, make sure to put the Mesh Filter between the heater unit inlet pipe and incoming water pipe.
7. For Pump model, it must never be connected to a Direct Main Water Supply, otherwise it will cause damage to the pump motor. It is recommended to connect the water supply from tank only.
 - Turn on the water mains to drain out all plumbing dirt and to fill up the heater tank. The heater tank must be filled up with water before turning on the electricity supply. This to prevent any dry burnt damages to the heating element.
 - Connect the PVC Hose and Handshower to the outlet of the Heater, be sure to put in the water.
 - Hook the Handshower to the Slider Rail Shower Holder and adjust to your ideal position.
 - Check for any water leakage.
 - Do not use white tape during installation.
8. The water inlet and outlet must be installed correctly, otherwise the heater cannot function.
9. Do not use plumbing cement on connection. If necessary, use only thread or sealing tape.

WARNING !

1. This appliance must be EARTHED. Improper grounding could cause electrical shock.
2. Remember to SWITCH OFF at mains before carrying out any electrical work.
3. Refer to the previous TABLE 1 for the correct cable size.
4. Use double coated flexible cable having nominal cross-sectional area between 2.5mm².
5. Lead the power cable from the MCB to a "ON/OFF" double pole linked switch having a contact separation of at least 3mm in all poles outside the bathroom, then lead a cable connected to terminal block inside the unit. (Fig.4)

PROCEDURE:

1. Insert the cable through 'A' for side entry or 'B' for wall embedded cable by cutting a hole through the source cord rubber holder. (Fig.5)
2. Connect the cable to Terminal Block and fully tighten them as follow
 BROWN or RED — LIVE (L)
 BLUE or BLACK — NEUTRAL (N)
 GREEN or GREEN/YELLOW — EARTH (⊕)
3. When replace back the Front Cover, please take note the below procedure:
 - To ensure the correct position, turn the Temperature VR Knob insert to OFF position as shown in Fig A. (at the Heater Base)
 - To install the Front Cover, turn the Temperature Control Knob to OFF position to align with the VR Knob Insert as shown in Fig B. (at the Front Cover)
4. Fix back the screw 'A'.

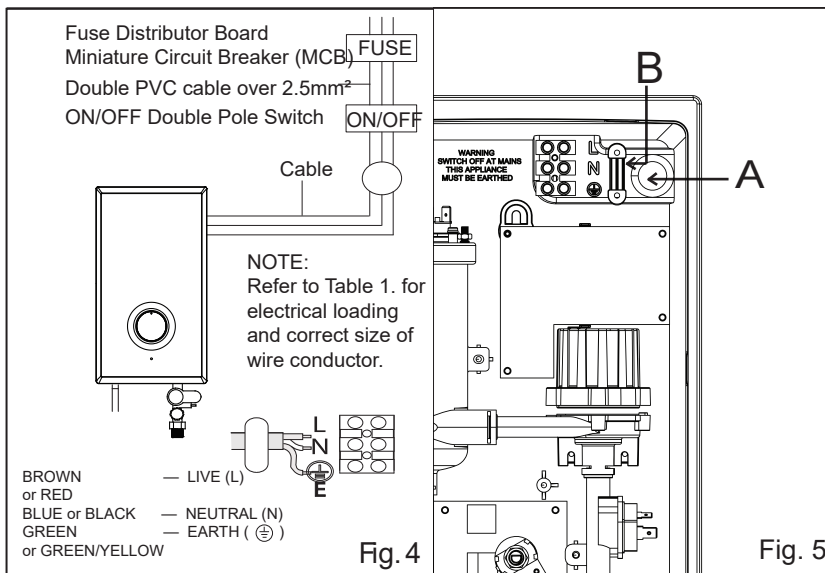

METHOD OF ALIGNMENT WHEN FIXING FRONT COVER

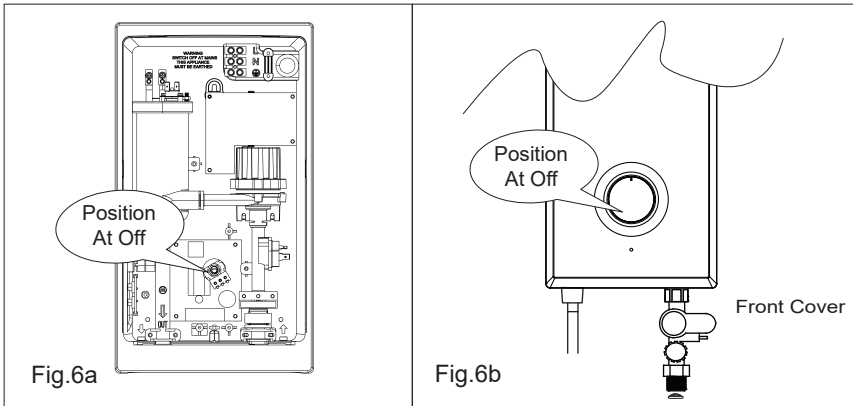
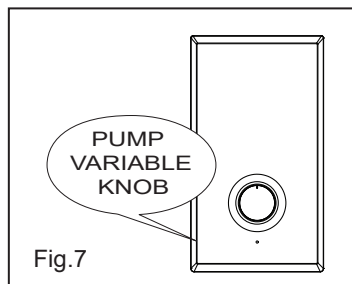

TABLE 1 - ELECTRICAL LOADING TABLE

Voltage (AC)	Power (kW)	Current (A)	Minimum Conductor Size (csa)			On/Off Switch (A)	Fuse / MCB (A)	
			mm ²	Conduit Cable	Flexible Cable			
240~ 50/60Hz	2.5	10.4	2.5	7 / 0.67 mm	50 / 0.25 mm	20	20	
	3.3	13.8	2.5	7 / 0.67 mm	50 / 0.25 mm	20	20	
	3.6	15.0	2.5	7 / 0.67 mm	50 / 0.25 mm	20	20	
	4.0	16.7	2.5	7 / 0.67 mm	56 / 0.25 mm	20	20	
	5.0	20.8	4.0	7 / 0.85 mm	56 / 0.30 mm	32	32	
	(Malaysia/Modat)	3.6	15.0	4.0	7 / 0.85 mm	56 / 0.30 mm	20	20
		3.8	15.9	4.0	7 / 0.85 mm	56 / 0.30 mm	20	20
		4.5	18.8	4.0	7 / 0.85 mm	56 / 0.30 mm	32	32
	4.8	20.0	4.0	7 / 0.85 mm	56 / 0.30 mm	32	32	
230~ 50/60Hz	2.4	10.4	2.5	7 / 0.67 mm	50 / 0.25 mm	20	20	
	3.0	13.0	2.5	7 / 0.67 mm	50 / 0.25 mm	20	20	
	3.3	14.4	2.5	7 / 0.67 mm	50 / 0.25 mm	20	20	
	4.0	17.4	2.5	7 / 0.67 mm	56 / 0.25 mm	20	20	
	5.0	21.8	4.0	7 / 0.85 mm	56 / 0.30 mm	32	32	
220~ 50/60Hz	2.4	10.9	2.5	7 / 0.67 mm	50 / 0.25 mm	20	20	
	3.5	15.9	2.5	7 / 0.67 mm	56 / 0.25 mm	20	20	
	4.5	20.5	2.5	7 / 0.67 mm	56 / 0.25 mm	32	32	
	5.5	25.0	4.0	7 / 0.85 mm	56 / 0.30 mm	32	32	
	6.0	27.3	4.0	7 / 0.85 mm	56 / 0.30 mm	32	32	

TEST RUN

1. Turn on the water supply and Stop Valve, the water will flow through the Handshower.
2. Switch on the electrical supply.
3. Turn the Temperature Control Knob to 'ON', the red indicator light (Power) will turn on, hot water will flow out within a few seconds. The more Temperature Control Knob being turned in clockwise direction, the hotter the shower is.
4. The shower might not be hot enough even at 'MAX' position if incoming water supply from the mains is too cold or pressure water is too high. In this case, you may adjust the Stop Valve to reduce the water inflow in order to get the desired showering temperature.
5. Check the Built-in RCD as following:
 - Press the "TEST" button, the Built-in RCD should trip and cut off the power supply, the Earth/RCD LED indicator should blink red.
 - Press the "RESET" button, the heater unit should resume normal function. All LED indicators should light up.If procedures stated above prevailed, the RCD is functioning in normal condition.
6. Switch OFF the electricity supply after shower.
7. For Pump Models: Turn the Pump Knob to test on Pump's functionality.
If the shower is not hot enough, you may adjust the stop valve until the desired shower temperature is obtained.



HANDSHOWER SPRAY ACTION

This innovative adjustable Handshower has 5 different spray actions (Standard, Jumbo, Soothe, Mix and Massage). The action are describe as follows.

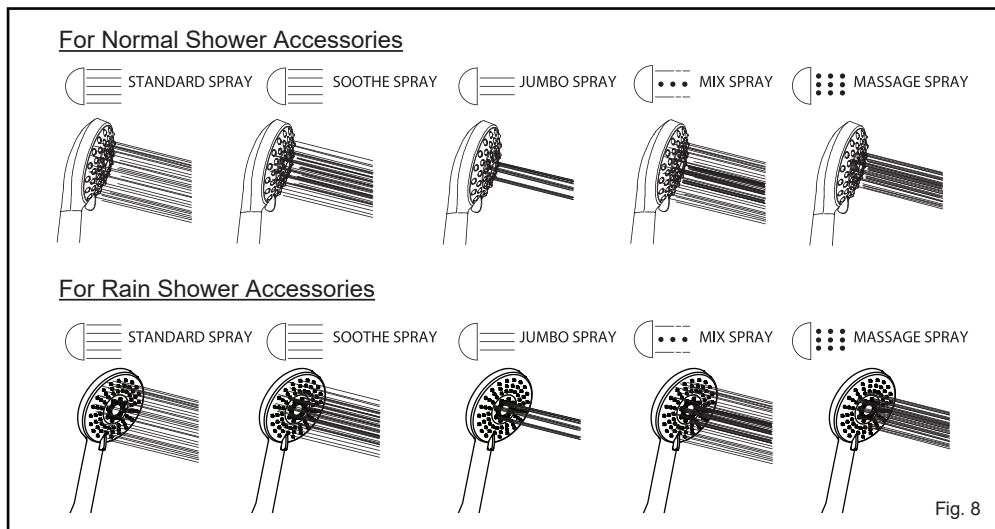

Clean the Handshower Head holes by using the soft brush from time to time.
(Recommended once a week)

Note: Take care not to damage the holes of the Handshower Head during cleaning.

It is highly recommended to test the built-in RCD in the water heater and at the main switch board at least once a month.

- Turn on the electricity and water supply, all LED indicators will light up. If the Temperature Control Knob is in "ON" position, the power LED will light up also. Press the RCD button, the RCD/Earth lamp should turn RED and start blinking. Press the Reset button to resume back the electricity supply.

If the RCD or HEATER lamp does not blink red when you press the RCD Test button, SWITCH OFF the mains supply and contact your sales agent for repair. Special skill is required for repair. NEVER try to repair the unit by yourself.

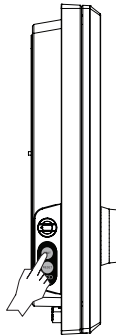

Main switch board

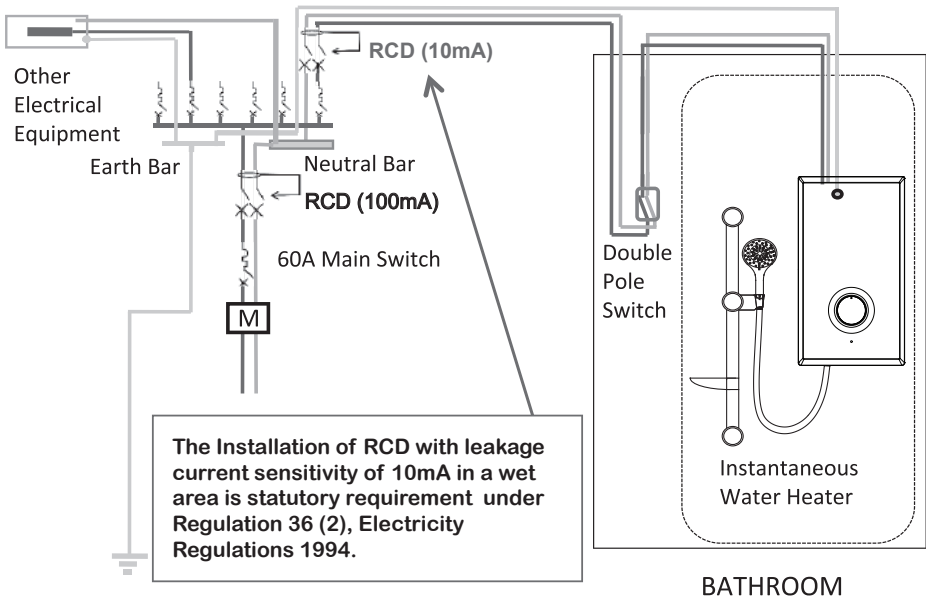

Figure 14: The installation of RCD for instantaneous water heater with leakage current sensitivity of 10mA in a wet area.

CLEANING PRECAUTION!

Do not use thinner, alcohol, petrol or any other organic solution to clean the set, use only a damp cloth with mild detergent.

CLEAN THE FILTER REGULARLY (Fig. 15 & Fig. 16)

There are two filter located at the stop valve, one is Mesh Filter (installed at the incoming water supply), another one is the built-in filter as shown in Fig. 16).

Clean the Mesh Filter regularly to prevent blockage. Remove the built-in filter by turn it anti-clockwise as shown in Fig. 15. Take out the Filter and flush it with water to remove any trapped sediments. (as shown in Fig. 16)

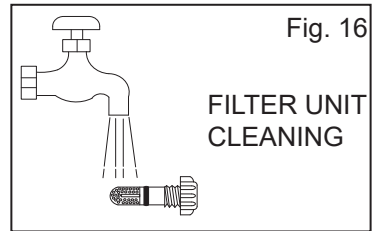
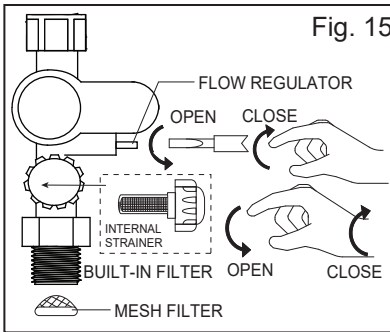

WIRING DIAGRAM

WIRING DIAGRAM - DC PUMP MODEL

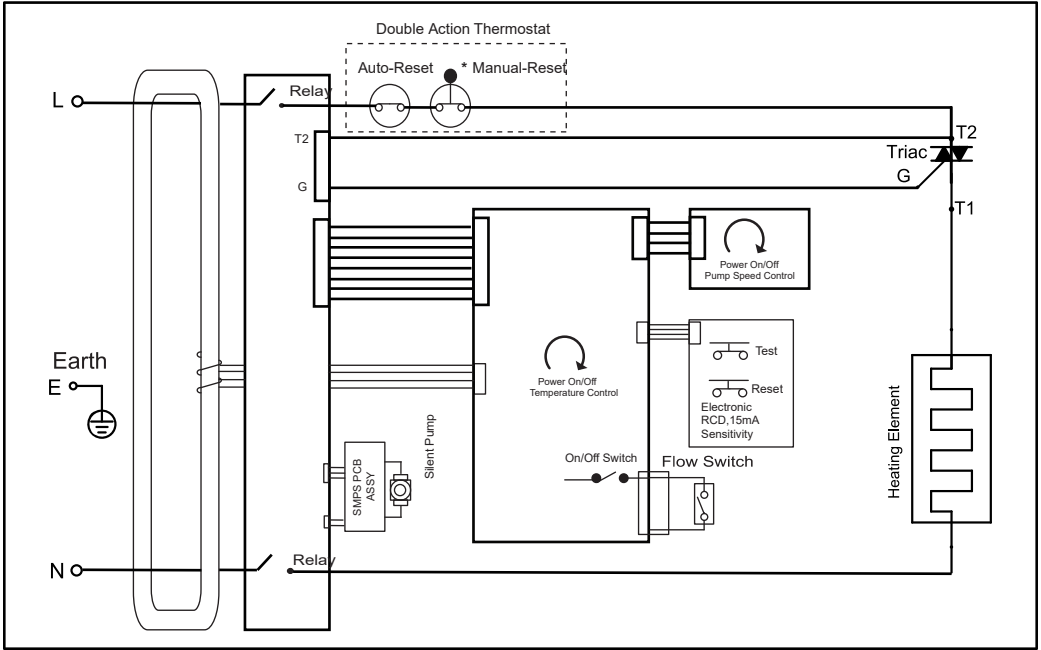

WIRING DIAGRAM - NO PUMP DPDT MODEL

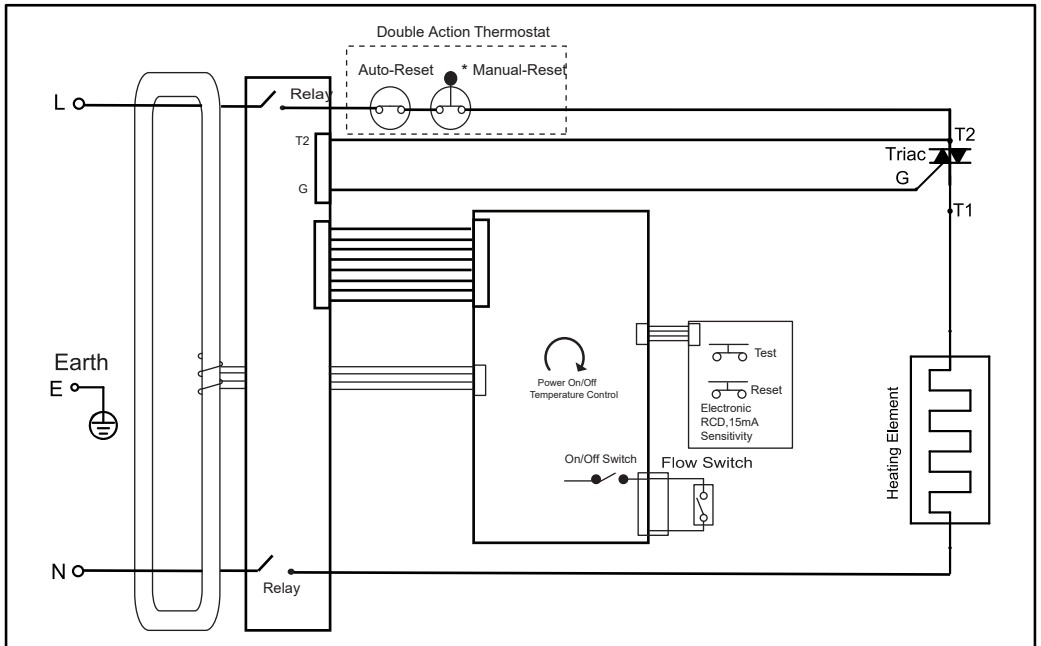

WIRING DIAGRAM

WIRING DIAGRAM - NO PUMP NO RCD MODEL

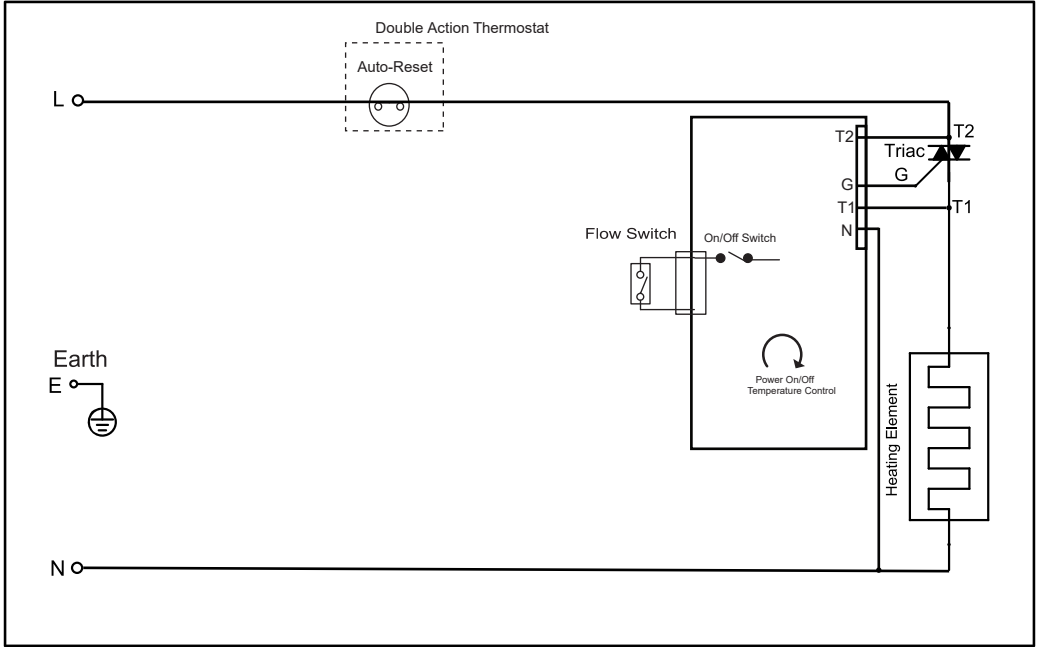

* Manual Reset (90°C Thermostat)
For Models rated 4.5kW and below, thermostat is manually resettable.

ELECTRICAL SPECIFICATION

TYPE	ELECTRONIC POWER CONTROL
ELECTRICAL LOADING	2.4kW - 6.0kW 220V - 240Va.c. 50/60Hz
Min. WATER FLOW RATE	2 Liter / min.
Min. INLET WATER PRESSURE	0.1 Bar (10kPa)
Max. INLET WATER PRESSURE	6 Bar (0.6MPa)
WATER CONNECTION	1/2" BSP SINGLE POINT SYSTEM
DIMENSIONS	365 x 204 x 103 (mm)
NETT WEIGHT	1.4kg (No Pump) 1.8kg (DC Pump)

Note : The specification, actual product's cosmetic design and accessories parts shown are correct at the time of printing and may be subjected to change without prior notice.

GERMANY 

LIVINOX

FOR A BETTER LIFESTYLE

Livinox Malaysia Sdn Bhd (1089457-U)
No 32A, Jalan Teknologi 3/3A,
Taman Sains Selangor 1, Kota Damansara,
47810 Petaling Jaya, Selangor.

www.livinox.my



Careline 
+603-6150 7810

